

C



JAY R. SMITH MFG. CO.
 MEMBER OF MORRIS GROUP INTERNATIONAL
 POST OFFICE BOX 3237
 MONTGOMERY, ALABAMA 36109-0237 (USA)
 TEL: 334-277-8520 FAX: 334-272-7396 www.jrsmith.com



MEMBER OF:



LOCATION

DRAWING NUMBER
S9703

SIZE
A

SCALE:
NONE

DATE:
11-12-84

APPROVED BY:
T.D.

CHECKED BY:
VGD

DRAWN BY:
P.J.

9703/9704

FIGURE NUMBER

WE CAN ASSUME NO RESPONSIBILITY FOR USE OF SUPERSEDED OR VOID DATA

DIMENSIONS ARE SUBJECT TO MANUFACTURERS TOLERANCE AND CHANGE WITHOUT NOTICE

FUNNELS

STAINLESS STEEL - CARBON STEEL

FUNCTION: Used to receive waste water from indirect waste lines. Funnel are attached to the grate with concealed bolts permitting funnel to be moved to different positions on the grate.

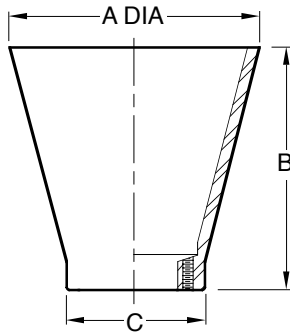

Fig. 9703 . . . 4" (100) FUNNEL

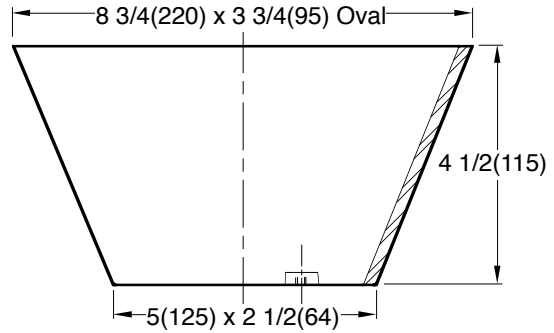

Fig. 9704 . . . 8 3/4"(220) x 3 3/4"(95) FUNNEL

A	B	C
4 (100)	4 1/4 (110)	2 1/2 (64)
6 (150)	4 1/2 (115)	2 1/2 (64)

REGULARLY FURNISHED:

CF8 (Equivalent to Type 304) Rough
 Finish Stainless Steel with Stainless Steel
 Bolts and Washers.

VARIATIONS:

- 6" (150) Funnel -6
- Satin Finish -SF

OPTIONAL MATERIALS:

- A-27 Carbon Steel -A27
- CF8M (Equivalent to Type 316) Stainless Steel -316
- Nickel Bronze -NB

NOTE: Dimensions shown in parentheses are in millimeters.

C	12-12-95	Added Millimeters	CMB	BS	WEIGHT POUNDS	VOLUME CUBIC FEET	FIGURE NUMBER 9703/9704
B	9-94	Submittal Update	CMB	BS			
A	3-93	Rev. Reg. Furn.	EMB				
REV.	DATE	DESCRIPTION	BY	CKD. BY			