

STAINLESS STEEL P-TRAP

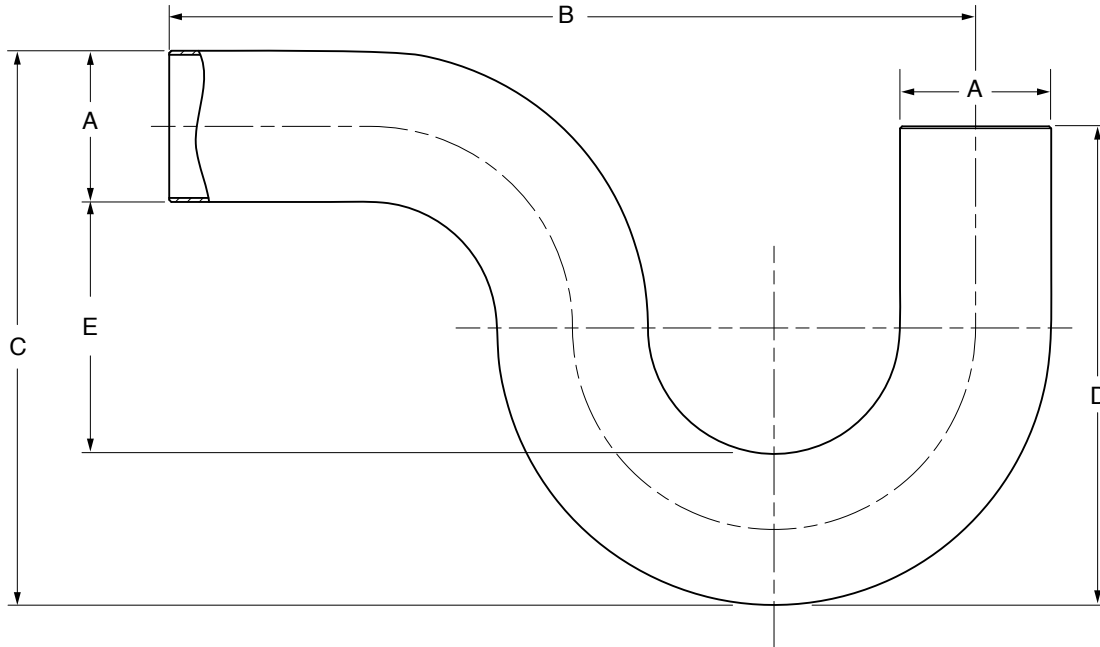

FIG. NO.	A=PIPE SIZE	B	C	D	E
9650BW02-S10	02(20)	12(305)	8.37(213)	7.19(183)	3.62(92)
9650BW03-S10	03(75)	19.50(495)	12.50(318)	12.25(311)	5.50(140)
9650BW04-S10	04(100)	24(610)	16.50(419)	14.25(362)	7.50(191)
9650BW06-S10	06(150)	33(838)	24.63(626)	18.31(465)	11.38(289)
9650BW08-S10	08(200)	42(1067)	32.63(829)	22.31(567)	15.38(391)

REGULARLY FURNISHED:
 Type 304 Stainless Steel
 P-Trap with Schedule 10
 Buttweld Connections.

NOTE: Dimensions shown in parentheses are in millimeters.

9650 SERIES

DIMENSIONS ARE SUBJECT TO MANUFACTURERS TOLERANCE AND CHANGE WITHOUT NOTICE

WE CAN ASSUME NO RESPONSIBILITY FOR USE OF SUPERSEDED OR VOID DATA

DRAWING NUMBER: **S9650 Series**
 SIZE: **A**
 SCALE: **NONE**
 DATE: **1-27-17**
 APPROVED BY: **SJM**
 CHECKED BY: **JM**
 DRAWN BY: **TBW**

REV.	DATE	DESCRIPTION	BY	CKD. BY	WEIGHT POUNDS	VOLUME CUBIC FEET	FIGURE NUMBER 9650 SERIES
		Removed Variations & Opt. Mat. Revised Table Dims., Draw., Var. Revised Table Dimensions Rev. Table, Reg. Furn., Add Var.	KK MW MW TBW	CL CL CL CL			