

E



**JAY R. SMITH MFG. CO.**  
 MEMBER OF MORRIS GROUP INTERNATIONAL  
 POST OFFICE BOX 3237  
 MONTGOMERY, ALABAMA 36109-0237 (USA)  
 TEL: 334-277-8520 FAX: 334-272-7396 www.jrsmith.com



MEMBER OF:

LOCATION

DRAWING NUMBER  
S4940SIZE  
ASCALE:  
NONEDATE:  
2-16-70APPROVED BY:  
JMCHECKED BY:  
BHDRAWN BY:  
RK

4940

FIGURE  
NUMBER

WE CAN ASSUME NO RESPONSIBILITY FOR USE OF SUPERSEDED OR VOID DATA

DIMENSIONS ARE SUBJECT TO MANUFACTURERS TOLERANCE AND CHANGE WITHOUT NOTICE

# FLOOR ACCESS COVERS

## SQUARE FRAME WITH SECURED COVER

**FUNCTION:** Used in concrete floors and surfaced areas subject to normal foot traffic, to provide access to cleanouts, valves, controls or equipment. Hinged covers are recommended for frequently used types of installations.

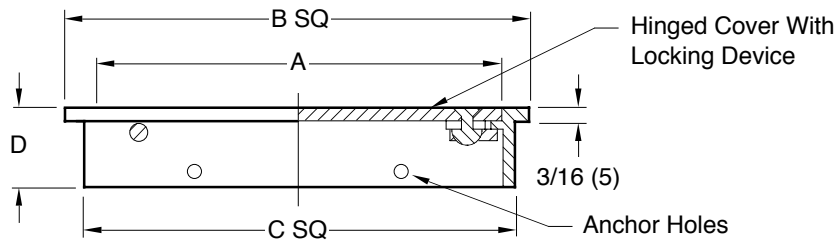

Fig. 4940

A SIZE	B SQ	C SQ	D
-08 x 08 (205) x (205)	9 (230)	8 3/4 (220)	1 1/2 (38)
-10 x 10 (255) x (255)	12 (305)	10 1/2 (265)	1 3/4 (44)

### REGULARLY FURNISHED:

Square Nickel Bronze Frame and Hinged Scoriated Cover with Locking Device.

### VARIATIONS:

Smooth Top -ST

### OPTIONAL MATERIALS:

Polished Bronze -PB

**NOTE:** Dimensions shown in parentheses are in millimeters.

REV.	DATE	DESCRIPTION	BY	CKD. BY
E	10-7-99	Revised	SA	BS
D	1-25-96	Added Millimeters	EMB	BS
C	7-27-94	Revised	TWK	BS
B	8-18-93	Submittal Update	CR	BS
A	3-2-83	Revised and Redrawn	BS/JM	BS/JM

WEIGHT  
POUNDSVOLUME  
CUBIC FEET

FIGURE NUMBER

4940