

GUTTER DRAINS

FUNCTION: Used in gutters where a drain is required for connecting to the downspout leader. Flashing arrangement design permits removal of dome or flat strainer without disturbing flashing clamp and gutter liner.

FLAT STRAINER Does not obstruct traffic	LOW DOME Intercepts debris and allows adequate drainage in gutters and valleys	HIGH DOME Used where an abnormal amount of debris is anticipated
---------------------------------------------------	------------------------------------------------------------------------------------------	----------------------------------------------------------------------------

BOTTOM OUTLET

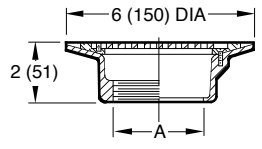

Fig. 1610T
Free Area: 7 SQ IN (45) SQ CM

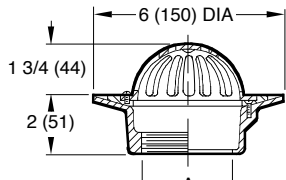

Fig. 1620T
Free Area: 8 SQ IN (52) SQ CM

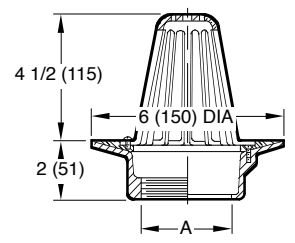

Fig. 1630T
Free Area: 24.5 SQ IN (158) SQ CM

A SIZE	02 (50)	02 (50)	03 (75)	04 (100)
OUTLET	Thread	Caulk	Thread	Thread
2"(51) Deep Body	✓	✓	✓	-
4"(100) Deep Body	✓	✓	✓	✓

REGULARLY FURNISHED:
 2" (51) Deep Body
 Threaded Outlet

45° OUTLET

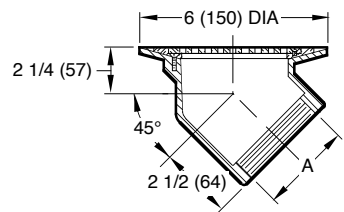

Fig. 1640T
Free Area: 7 SQ IN (45) SQ CM

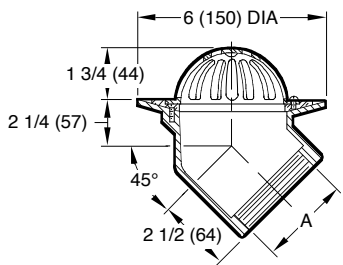

Fig. 1650T
Free Area: 8 SQ IN (52) SQ CM

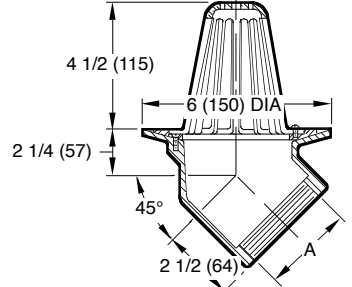

Fig. 1660T
Free Area: 24.5 SQ IN (158) SQ CM

Available In Threaded Outlet Only
 A (Pipe Size) = 02(50), 03(75) or 04(100)

SIDE OUTLET

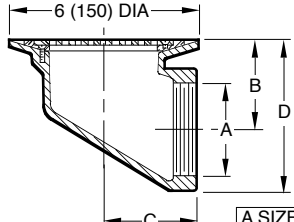

Fig. 1670T
Free Area: 7 SQ IN (45) SQ CM

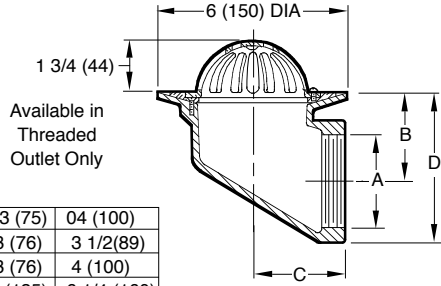

Fig. 1680T
Free Area: 8 SQ IN (52) SQ CM

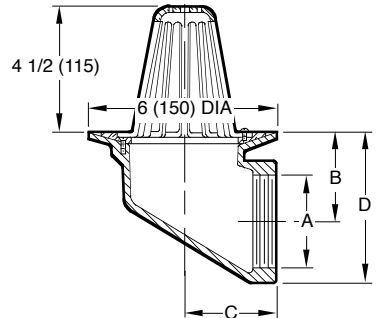

Fig. 1690T
Free Area: 24.5 SQ IN (158) SQ CM

REGULARLY FURNISHED:
 Duco Cast Iron Body with Bronze Flashing Clamp and Bronze Top Secured with Brass Screws.

NOTE: Dimensions shown in parentheses are in millimeters.

- VARIATIONS:**
- 4" (100) Deep Body -B4 (Fig. 1610, 1620, 1630 only)
 - Vandal Proof Screws -U
 - Stainless Steel Mesh Over Dome -SSM

- OPTIONAL MATERIALS:**
- Galvanized Cast Iron Body -G
 - Nickel Bronze Top -NB
 - Polished Bronze Top -PB
 - Bronze Body -BB

DRAWING NUMBER: S1600
 SIZE: A
 SCALE: NONE
 DATE: 5-24-85
 APPROVED BY: TD
 CHECKED BY: TD
 DRAWN BY: CR
1600 Series

WE CAN ASSUME NO RESPONSIBILITY FOR USE OF SUPERSEDED OR VOID DATA
 DIMENSIONS ARE SUBJECT TO MANUFACTURERS TOLERANCE AND CHANGE WITHOUT NOTICE

REV.	DATE	DESCRIPTION	BY	CKD. BY	WEIGHT POUNDS	VOLUME CUBIC FEET	FIGURE NUMBER
							1600 Series