



JAY R. SMITH MFG. CO.
MEMBER OF MORRIS GROUP INTERNATIONAL



Stainless Steel Threshold Drain™

For use in front of elevators, doorways, stairways and similar applications to receive and drain water with flow rates up to 100 GPM.

FEATURES AND BENEFITS

- Complies with 2013 California Building Code 403.6.1, 403.6.2, 3007.4, 3008.4
- Complies with San Francisco Fire Code, Section 511.1.4
- 3007.3 Water protection. The occupant evacuation elevator hoistway and associated elevator landings shall be designed by an approved method to prevent water from infiltrating into the shaft enclosure
- For use in front of elevator doors and similar applications
- Complies with 2013 CA building code 403.6.1, 3007.4
- Third party certified to 100 gpm flow rate
- ADA compliant
- Heel proof
- 1 3/4" deep does not disturb post-tension slabs
- 304 Stainless Steel
- Removable grating



Fig. No. 9679



Patent #10,167,621

Stainless Steel Threshold Drain™



The Jay R. Smith Mfg. Co. Figure number 9679 Threshold Drain™ is engineered to be in compliance with current building codes addressing fire service access elevators that require protection from water that could enter the elevator shaft during a fire. The 9679 threshold drain is certified to flow 100 gpm with an ADA compliant grate. The threshold drain can be manufactured to custom lengths to meet facility requirements.

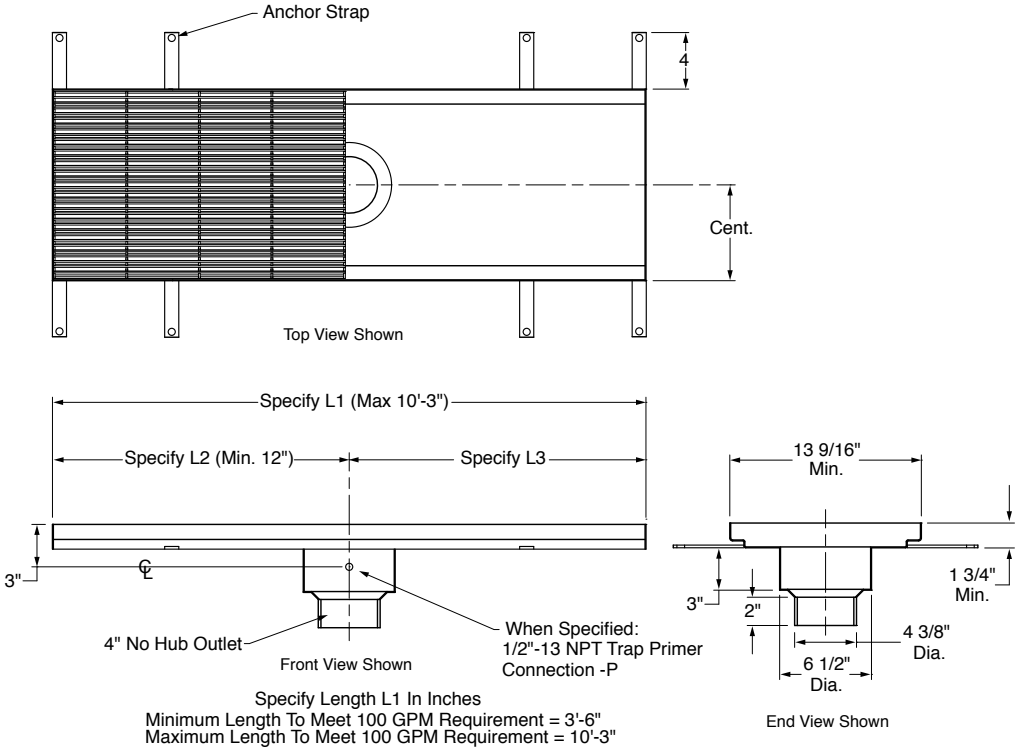

- Option A - without flange
- Option B - flange w/clamping collar and weep holes



JAY R. SMITH MFG. CO.
MEMBER OF MORRIS GROUP INTERNATIONAL

P.O. Box 3237 • Montgomery, AL 36109
TEL: 334.277.8520

www.jrsmith.com

